

Forked collar sockets

■ GI52/45,B20 Forked collar socket

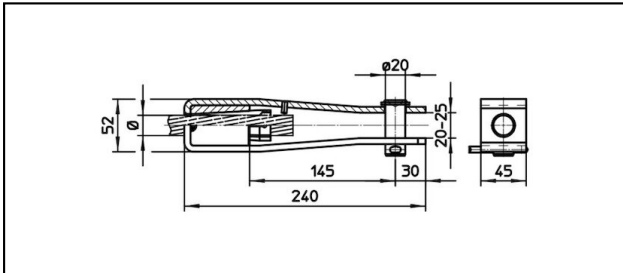

Application

Tensioned Cu, Cu-Steel, steel or Bz cables

Characteristics

Service load min. 3 kN / max. 25 kN







Breaking load of corpus min. 120 kN

Material

Corpus stainless steel / Collet AlBz resp. stainless steel

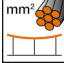
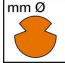
Legend

1) Collet of stainless steel for steel cables

Article-Nr.									
610.000.010	S144	15.8	144					1.66	

Technical Specifications: **Forked collar socket GI52/45,B20**

Article No.	610.000.010
Rail product name	S144
Catenary wire diameter	15.8 mm
Catenary wire section	144 mm ²
Commercial specification	
Customs number	85359000
country of origin	CH
Logistic specification	
Kilo / piece	1.66 kg

